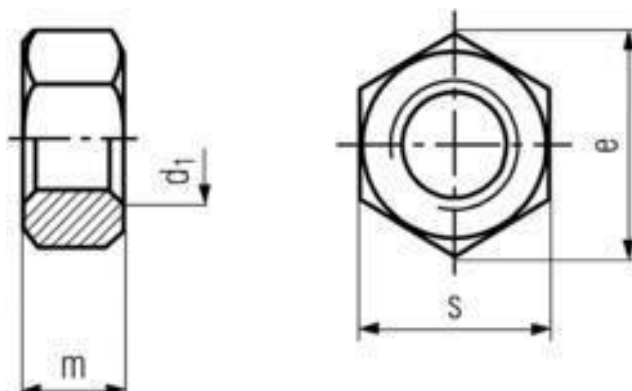
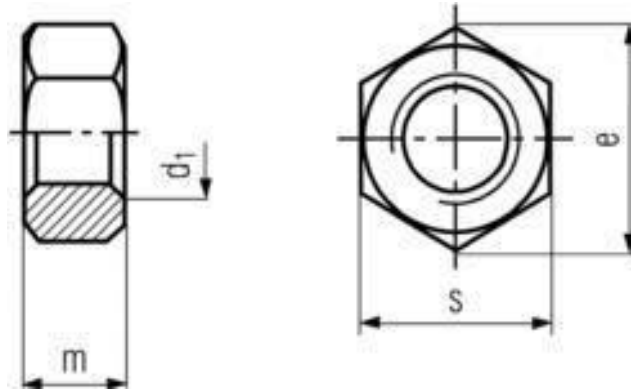
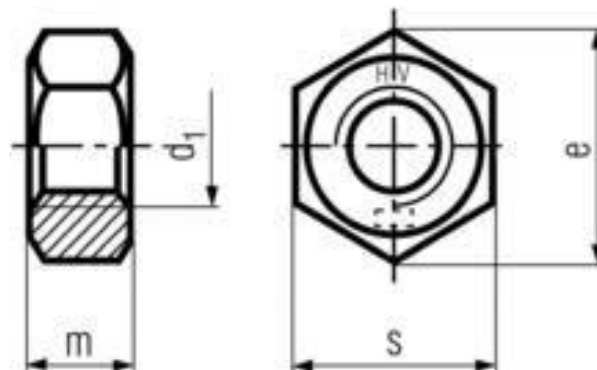

DIN 934 / ISO 4032 Hexagon Nuts**Quality:** 4.8 / 5.6 / 5.8 / 6.8 / 8.8 / 10.9 / 12.9 / Stainless**Coating Type:** Zinc Plated / Hot Dip Galvanized / Geomet / Black Oxide

d_1	s	e	m
M4	7	7.66	3.2
M5	8	8.76	4
M6	10	11.05	5
M7	11	12.12	5.5
M8	13	14.38	6.5
M10	17	18.9	8
M12	19	21.1	10
M14	22	24.49	11
M16	24	26.75	13
M18	27	29.56	15
M20	30	32.95	16
M22	32	35.03	18
M24	36	39.55	19
M27	41	45.2	22
M30	46	50.85	24
M33	50	55.37	26
M36	55	60.79	29
M39	60	66.44	31
M42	65	71.3	34
M45	70	76.95	36
M48	75	82.6	38
M52	80	88.25	42
M56	85	95.07	45
M60	90	100.72	48
M64	95	106.37	51

DIN 934 / ISO 4032 Hexagon Nuts**Quality:** 4.8 / 5.6 / 5.8 / 6.8 / 8.8 / 10.9 / 12.9 / Stainless**Coating Type:** Zinc Plated / Hot Dip Galvanized / Geomet / Black Oxide

d_1	s	e	m
M68	100	112.02	54
M72	105	117.67	58
M76	110	123.32	61
M80	115	128.97	64
M85	120	133.11	68
M90	130	145.77	72
M95	135	151.42	76
M100	145	162.72	80
M105	150	168.37	84
M110	155	174.02	88
M115	165	185.32	92
M120	170	190.97	96
M125	180	202.27	100
M130	185	207.75	104
M135	190	213.40	108
M140	200	224.70	112
M145	210	236	116
M150	210	236	120

DIN 6915 HV Structural Nuts**Quality:** 6.8 / 8.8 / 10.9 / 12.9**Coating Type:** Zinc Plated / Hot Dip Galvanized / Geomet / Black Oxide

d_1	s	e	m
M12	22	23.91	10
M16	27	29.56	13
M20	32	35.03	16
M22	36	39.55	18
M24	41	45.2	19
M27	46	50.85	22
M30	50	55.37	24
M36	60	66.44	29

DIN 936 Hexagon Nuts

Quality: 4.8 / 5.6 / 5.8 / 6.8 / 8.8 / 10.9 / 12.9 / Stainless

Coating Type: Zinc Plated / Hot Dip Galvanized / Geomet / Black Oxide

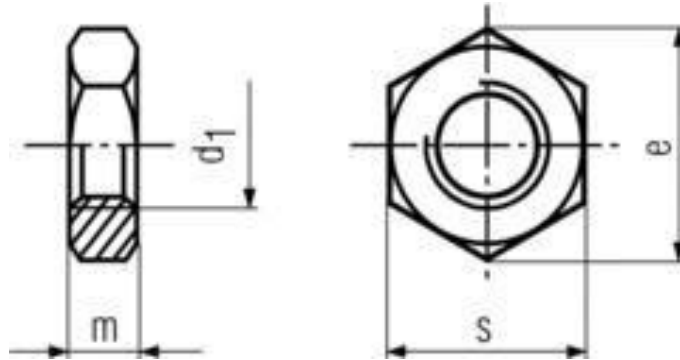

d_1	s	e	m
M8	13	14.38	5
M10	17	18.9	6
M12	19	21.1	7
M14	22	24.49	8
M16	24	26.75	8
M18	27	29.56	9
M20	30	32.95	9
M22	32	35.03	10
M24	36	39.55	10
M27	41	45.2	12
M30	46	50.85	12
M33	50	55.8	14
M36	55	61.31	14
M39	60	66.96	16
M42	65	72.61	16
M45	70	78.26	18
M48	75	83.91	18
M52	80	89.56	20

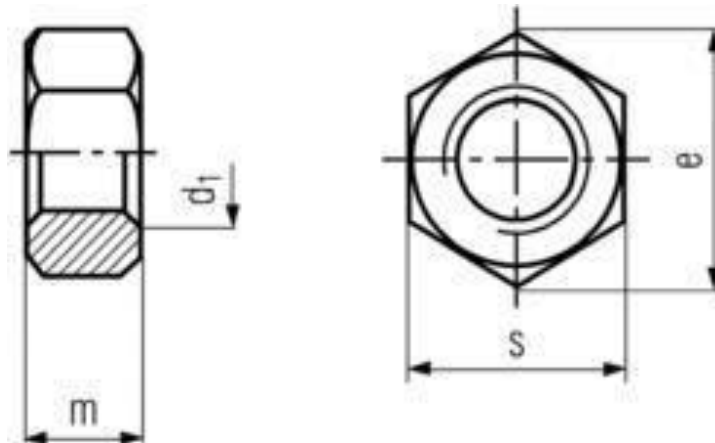
DIN 555 / ISO 4034 Hexagon Nuts**Quality:** 4.8 / 5.6 / 5.8 / 6.8 / 8.8 / 10.9 / 12.9 / Stainless**Coating Type:** Zinc Plated / Hot Dip Galvanized / Geomet / Black Oxide

d_1	s	e	m
M5	8	8.63	4
M6	10	10.89	5
M8	13	14.2	6.5
M10	17	18.72	8
M12	19	20.88	10
M14	22	24.49	11
M16	24	26.17	13
M18	27	29.56	15
M20	30	32.95	16
M22	32	35.03	18
M24	36	39.55	19
M27	41	45.2	22
M30	46	50.85	24
M33	50	55.37	26
M36	55	60.79	29
M39	60	66.44	31
M42	65	71.3	34
M45	70	76.95	36
M48	75	82.06	38
M52	80	88.25	42
M56	85	93.56	45
M60	90	99.23	48
M64	95	104.86	51

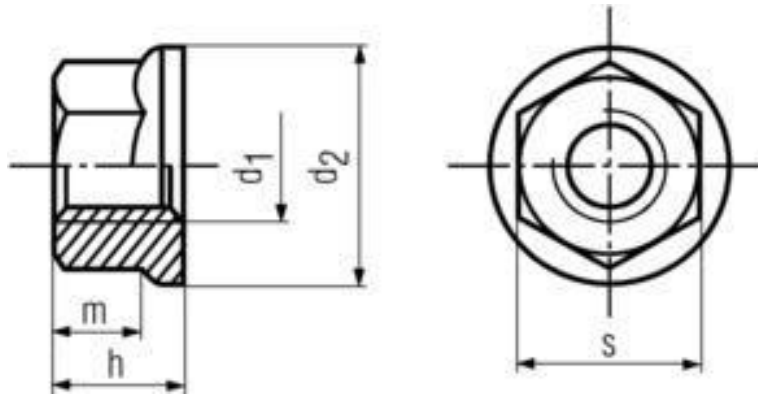
DIN 6923 / ISO 4161 Flange Hexagon Nuts**Quality:** 4.8 / 5.6 / 5.8 / 6.8 / 8.8 / 10.9 / 12.9 / Stainless**Coating Type:** Zinc Plated / Hot Dip Galvanized / Geomet / Black Oxide

d	d₁	s	m
M4	10	7	4.5
M5	11.8	8	5
M6	14.2	10	6
M8	17.9	13	8
M10	21.8	15	10
M12	26	18	12
M14	29.9	21	14
M16	34.5	24	16
M20	42.8	30	20

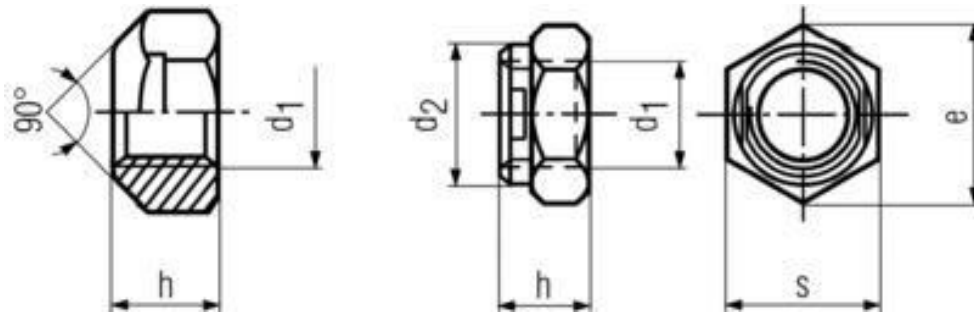
DIN 980 / ISO 7042 Hexagon Lock Nuts**Quality:** 4.8 / 5.6 / 5.8 / 6.8 / 8.8 / 10.9**Coating Type:** Zinc Plated / Hot Dip Galvanized / Geomet / Black Oxide

d_1	s	e min	d_2	h max
M4	7	7.66		4.2
M5	8	8.79		5.1
M6	10	11.05		6
M8	13	14.38		8
M10	17	18.9		10
M12	19	21.1		12
M14	22	24.49		14
M16	24	26.75		16
M18	27	29.56	23	18
M20	30	32.95	27.5	20
M22	32	35.03	29.5	22
M24	36	39.55	31	24
M27	41	45.02		
M30	46	50.85		
M33	50	55.37		
M36	55	60.79		

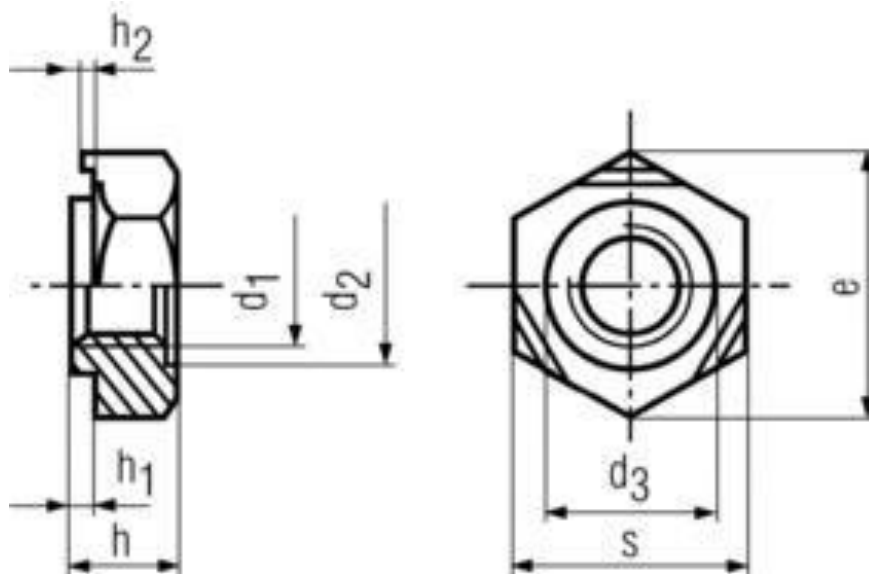
DIN 929 Hexagon Weld Nuts**Quality:** 4.8 / 5.6 / 5.8 / 6.8 / 8.8 / 10.9 / 12.9 / Stainless**Coating Type:** Zinc Plated / Hot Dip Galvanized / Geomet / Black Oxide

d ₁	d ₂ H13	d ₃ d11	h1	h2	h h14	s h13	Sheet Thickness			
							min.	max.		
M3	4.5	4.5	0.55	0-0.1	0.25	0-0.1	3	7.5	0.63	2.6
M4	6	6	0.65		0.35		3.5	9	0.75	3
M5	7	7	0.7		0.4		4	10	0.88	3.5
M6	8	8	0.75	0-0.15	0.4	0-0.15	5	11	0.88	4
M8	10.5	10.5	0.9		0.5		6.5	14	1	4.5
M10	12.5	12.5	1.15	0-0.2	0.65	0-0.2	8	17	1.25	5
M12	14.8	14.8	1.4		0.8		10	19	1.5	5
M14	16.8	16.8	1.8		1		11	22	2	6
M16	18.8	18.8	1.8		1		13	24	2	6

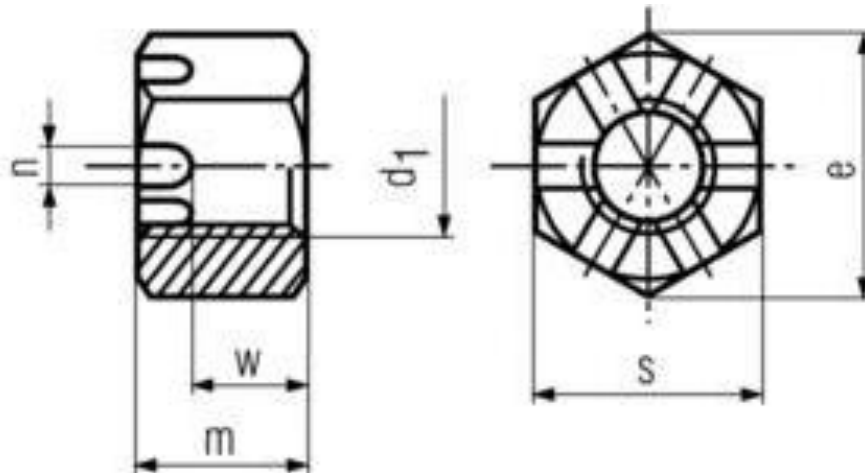
DIN 935/ ISO R 288/1 Hexagon Castle Nuts**Quality:** 4.8 / 5.6 / 5.8 / 6.8 / 8.8 / 10.9 / 12.9 / Stainless**Coating Type:** Zinc Plated / Hot Dip Galvanized / Geomet / Black Oxide

d₁	s max.	e	m max.	w max.	n min.
M4	7	7.74	5	3.2	1.2
M5	8	8.87	6	4	1.4
M6	10	11.05	7.5	5	2
M8	13	14.38	9.5	6.5	2.5
M10	17	18.9	12	8	2.8
M12	19	21.1	15	10	3.5
M14	22	24.49	16	11	3.5
M16	24	26.75	19	13	4.5
M18	27	29.56	21	15	4.5
M20	30	32.95	22	16	4.5
M22	32	35.03	26	18	5.5
M24	36	39.55	27	19	5.5
M27	41	45.2	30	22	5.5
M30	46	50.85	33	24	7
M33	50	55.37	35	26	7
M36	55	60.79	38	29	7
M39	60	66.44	40	31	7
M42	65	71.3	46	34	9
M45	70	78.26	48	36	9
M48	75	82.6	50	38	9
M52	80	88.25	54	42	9
M56	85	95.07	57	45	9
M60	90	100.72	63	48	11
M64	95	106.37	66	51	11
M68	100	112.02	69	54	11
M72	105	117.67	73	58	11
M76	110	123.32	76	61	11
M80	115	128.97	79	64	11
M85	120	134.62	88	68	14
M90	130	145.77	92	72	14
M95	135	151.42	96	76	
M100	145	162.72	100	80	14

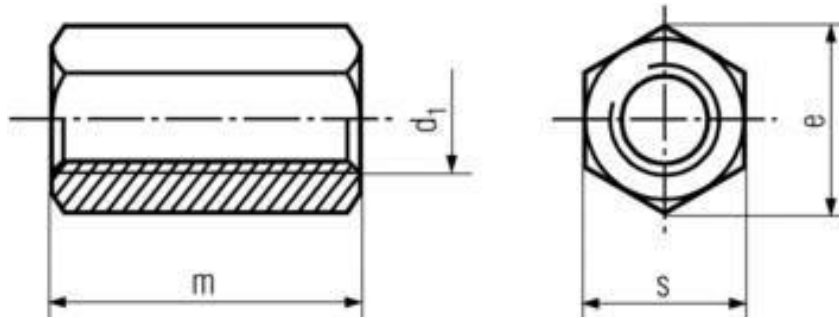
DIN 6334 Hexagon Nuts**Quality:** 4.8 / 5.6 / 5.8 / 6.8 / 8.8 / 10.9 / 12.9 / Stainless**Coating Type:** Zinc Plated / Hot Dip Galvanized / Geomet / Black Oxide

d_1	m	e	s
M6	18	11.05	10
M8	24	14.38	13
M10	30	18.9	17
M12	36	21.1	19
M16	48	26.75	24
M20	60	33.53	30
M24	72	41.6	36

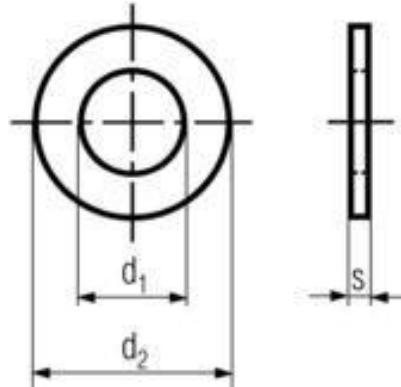
DIN 125 / ISO 7089 Plain Washers**Quality:** 4.8 / 5.6 / 5.8 / 6.8 / 8.8 / 10.9 / 12.9 / Stainless**Coating Type:** Zinc Plated / Hot Dip Galvanized / Geomet / Black Oxide

d_1	for thread size	d_2	s
4.3	M4	9	0.8
5.3	M5	10	1
6.4	M6	12	1.6
7.4	M7	14	1.6
8.4	M8	16	1.6
10.5	M10	20	2
13	M12	24	2.5
15	M14	28	2.5
17	M16	30	3
19	M18	34	3
21	M20	37	3
23	M22	39	3
25	M24	44	4
28	M27	50	4
31	M30	56	4
34	M33	60	5
37	M36	66	5
40	M39	72	6
43	M42	78	7
50	M48	92	8
54	M52	98	8

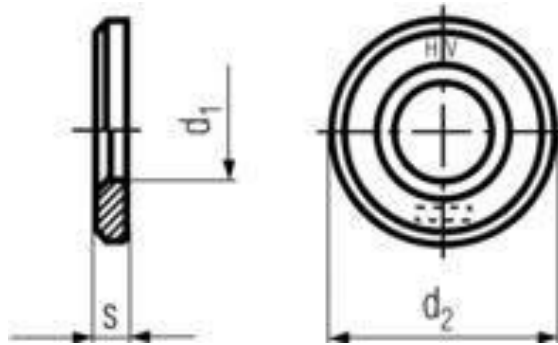
DIN 6916 / ISO 7416 HV Structural Washers**Quality:** 8.8 / 10.9 / 12.9**Coating Type:** Zinc Plated / Hot Dip Galvanized / Geomet / Black Oxide

d_1	used for	d_2	s
13	M12	24	3
17	M16	30	4
21	M20	37	4
23	M22	39	4
25	M24	44	4
28	M27	50	5
31	M30	56	5
37	M36	66	6

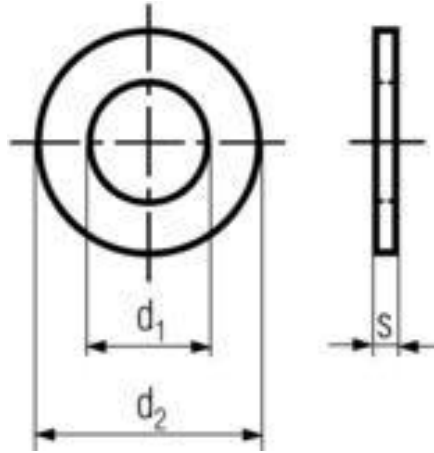
DIN 126 Flat Washers**Quality:** 4.8 / 5.6 / 5.8 / 6.8 / 8.8 / 10.9 / 12.9 / Stainless**Coating Type:** Zinc Plated / Hot Dip Galvanized / Geomet / Black Oxide

d_1	used for	d_2	s
5.5	M5	10	1
6.6	M6	12	1.6
7.6	M7	14	1.6
9	M8	16	1.6
11	M10	20	2
13.5	M12	24	2.5
15.5	M14	28	2.5
17.5	M16	30	3
22	M20	37	3
26	M24	44	4
30	M27	50	4
33	M30	56	4
36	M33	60	5
39	M36	66	5
42	M39	72	6
45	M42	78	7
48	M45	85	7
52	M48	92	8
56	M52	98	8
62	M56	105	9
66	M60	110	9
70	M64	115	9

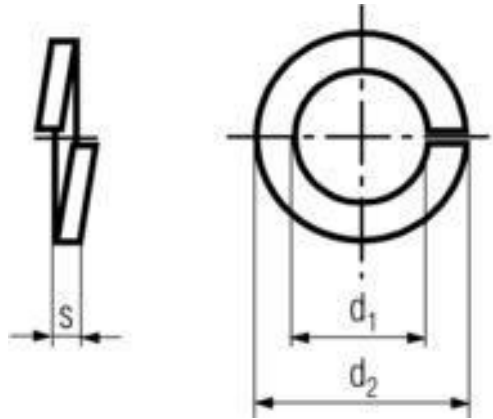
DIN 127 Spring Washers**Quality:** 4.8 / 5.6 / 5.8 / 6.8 / 8.8 / 10.9 / 12.9 / Stainless**Coating Type:** Zinc Plated / Hot Dip Galvanized / Geomet / Black Oxide

d_1	for screw size	d_2	s
2.1	M2	4.4	0.5
2.6	M2.5	5.1	0.6
3.1	M3	6.2	0.8
3.6	M3.5	6.7	0.8
4.1	M4	7.6	.09
5.1	M5	9.2	1.2
6.1	M6	11.8	1.6
8.1	M8	14.8	2
10.2	M10	18.1	2.2
12.2	M12	21.1	2.5
14.2	M14	24.1	3
16.2	M16	27.4	3.5
18.2	M18	29.4	3.5
20.2	M20	33.6	4
22.5	M22	35.9	4
24.5	M24	40	5
27.5	M27	43	5
30.5	M30	48.2	6
33.5	M33	55.2	6
36.5	M36	58.2	6
39	M38	61.2	6
42.5	M42	68.2	7
45.5	M45	71.2	7
49	M48	75	7
53	M52	86	8

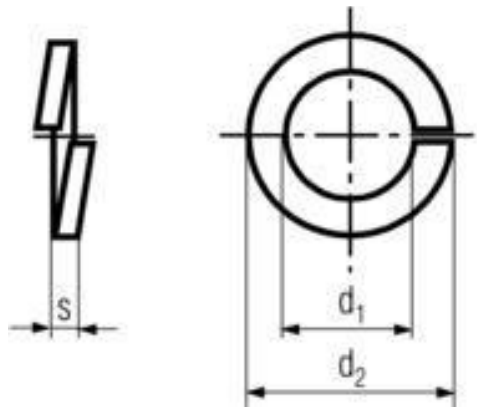
DIN 7980 Spring Washers**Quality:** 4.8 / 5.6 / 5.8 / 6.8 / 8.8 / 10.9 / 12.9 / Stainless**Coating Type:** Zinc Plated / Hot Dip Galvanized / Geomet / Black Oxide

d₁	used for	s	d₂
4.1	M4	1.2	7
5.1	M5	1.6	8.8
6.1	M6	1.6	9.9
8.1	M8	2	12.7
10.2	M10	2.5	16
12.2	M12	2.5	18
14.2	M14	3	21.1
16.2	M16	3.5	24.4
18.2	M18	3.5	26.4
20.2	M20	4.5	30.6
22.5	M22	4.5	32.9
24.5	M24	5	35.9
27.5	M27	5	38.9
30.5	M30	6	44.1
33.5	M33	6	47.1
36.5	M36	7	52.2

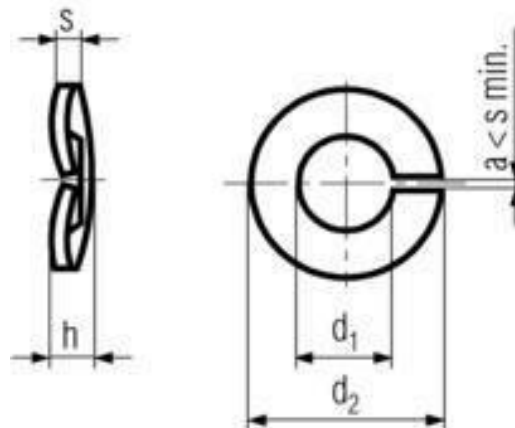
DIN 128 Spring Lock Washers**Quality:** 4.8 / 5.6 / 5.8 / 6.8 / 8.8 / 10.9 / 12.9 / Stainless**Coating Type:** Zinc Plated / Hot Dip Galvanized / Geomet / Black Oxide

d_1	for screw size	d_2	s	$h \text{ min}$	$h \text{ max}$
4.1	M4	7.6	0.8	1.2	1.4
5.1	M5	9.2	1	1.5	1.7
6.1	M6	11.8	1.3	2	2.2
8.1	M8	14.8	1.6	2.45	2.75
10.2	M10	18.1	1.8	2.85	3.15
12.2	M12	21.1	2.1	3.35	3.65
14.2	M14	24.1	2.4	3.9	4.3
16.2	M16	27.4	2.8	4.5	5.1
18.2	M17	29.4	2.8	4.5	5.1
20.2	M20	33.6	3.2	5.1	5.9
22.2	M21	35.9	3.2	5.1	5.9
24.5	M24	40	4	6.5	7.5
30.5	M30	48.2	6	9.5	10.5

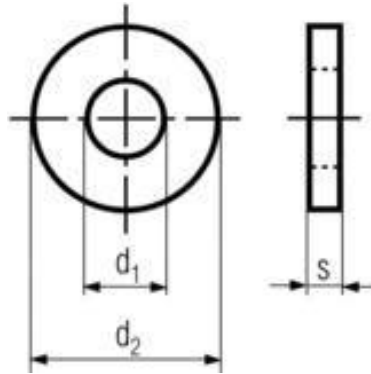
DIN 7349 Flat Washers**Quality:** 4.8 / 5.6 / 5.8 / 6.8 / 8.8 / 10.9 / 12.9 / Stainless**Coating Type:** Zinc Plated / Hot Dip Galvanized / Geomet / Black Oxide

D1	for spring pins DIN 1481	for screws	s	d ₂
4.3	8	M4	1.6	12
5.3	10	M5	2	15
6.4	12	M6	3	17
8.4	16	M8	4	21
10.5	18	M10	4	25
13	21	M12	6	30
15	25	M14	6	36
17	28	M16	6	40
21	35	M20	8	44
23	38	M22	8	50
25	40	M24	10	50
31	50	M30	10	68

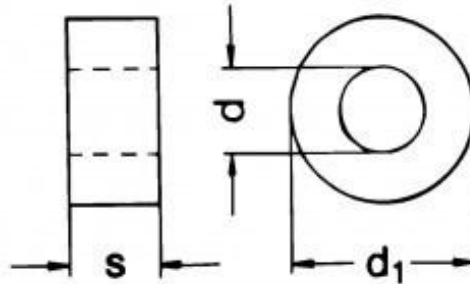
DIN 7989 Washers for Steel Constructions**Quality:** 4.8 / 5.6 / 5.8 / 6.8 / 8.8 / 10.9 / 12.9 / Stainless**Coating Type:** Zinc Plated / Hot Dip Galvanized / Geomet / Black Oxide

d_1	used for	d_2	s
11	M10	21	8
14	M12	24	8
18	M16	30	8
22	M20	37	8
26	M24	44	8
30	M27	50	8
33	M30	56	8

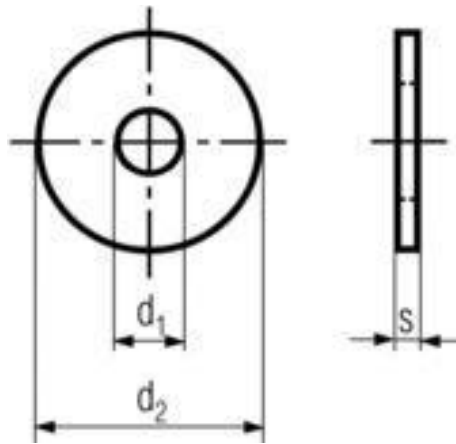
DIN 9021/ ISO 7093 Plain Washers**Quality:** 4.8 / 5.6 / 5.8 / 6.8 / 8.8 / 10.9 / 12.9 / Stainless**Coating Type:** Zinc Plated / Hot Dip Galvanized / Geomet / Black Oxide

d_1	used for	d_2 max	s
4.3	M4	12	1
5.3	M5	15	1.2
6.4	M6	18	1.6
8.4	M8	24	2
10.5	M10	30	2.5
13	M12	37	3
15	M14	44	3
17	M16	50	3
20	M18	56	4
22	M20	60	4